

# Alpair 10 MLTL

## Overall Assembly

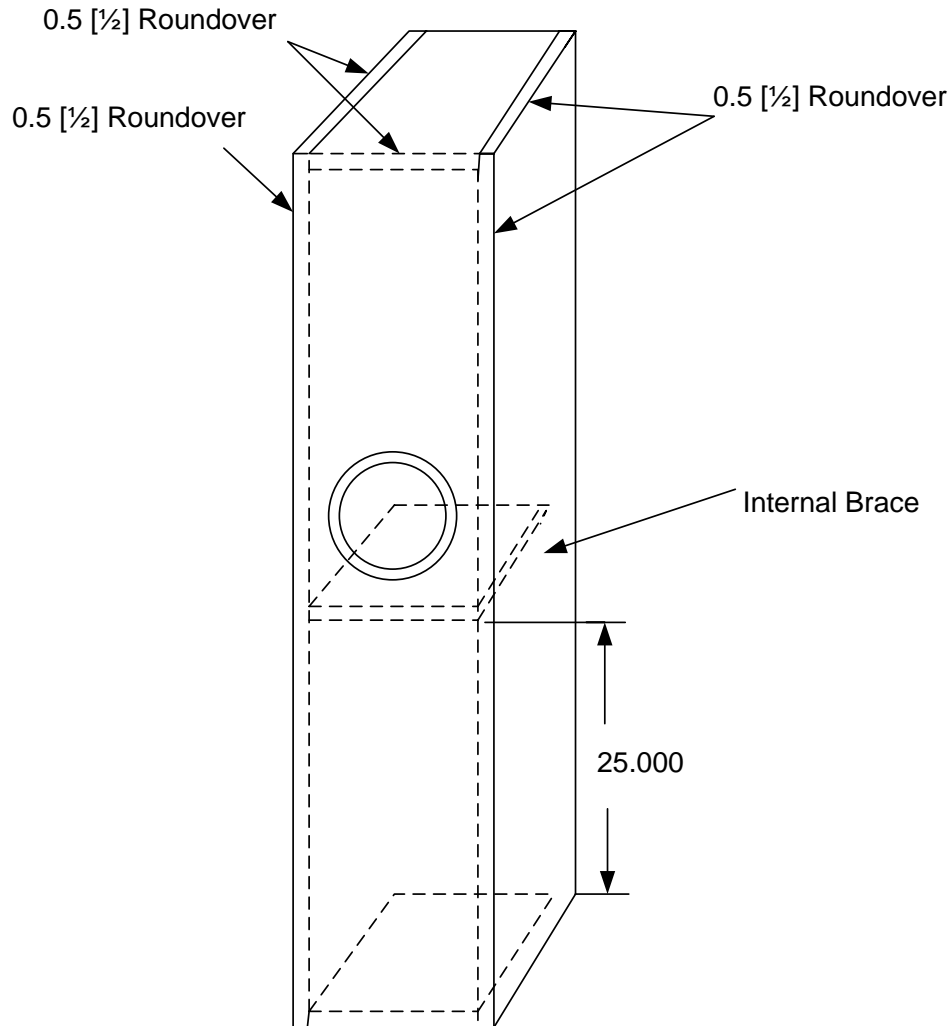

### Notes

1. All material is nominally 0.75 [3/4] thickness
2. Outside view of each panel is shown
3. Dimensions are nominal and inches.
4. Terminal plate dimensions for Madisound TD biamp cup
5. Port is 2.0625 [2 1/16] diameter and 4.0 long

©2008 Jim Griffin  
Noncommercial Use Only

# Alpair 10 MLTL

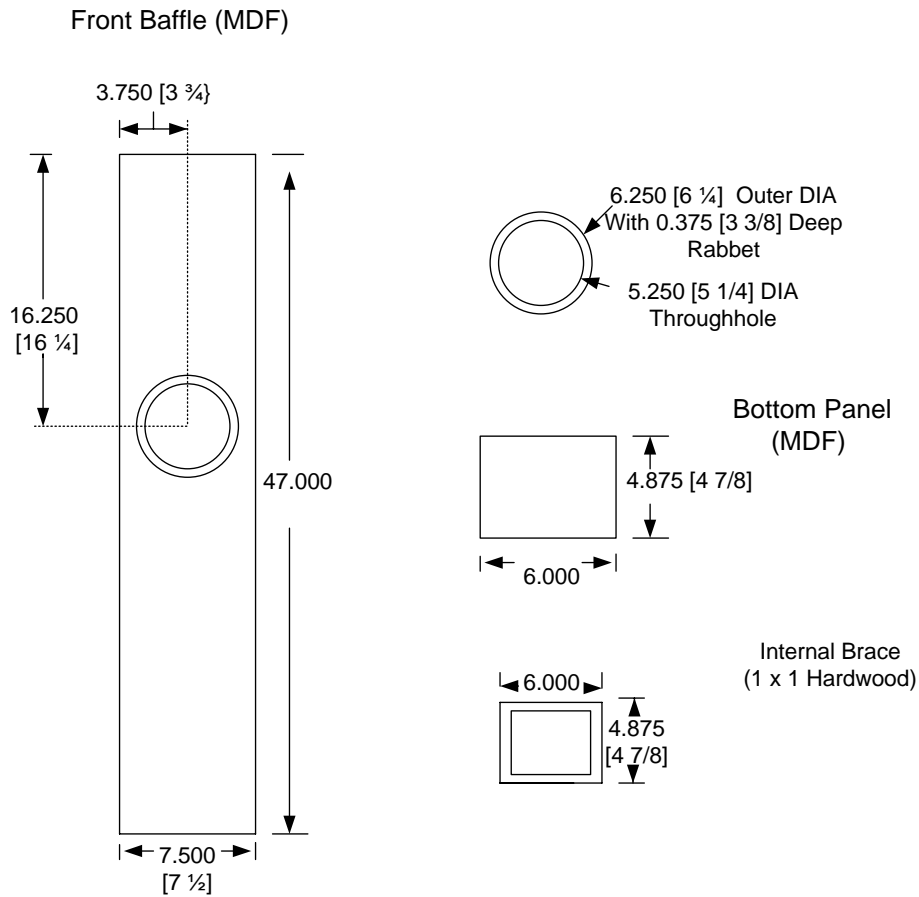

©2008 Jim Griffin  
Noncommercial Use Only

"The stuffing density is 0.5 pound per cubic foot. In my prototypes I used Acousta Stuf(Trademark) damping fiber but similar material will suffice. The stuffing should extend from below the driver to the top of the box. I place a coarse metal grid or screen on top of the internal brace to prevent the stuffing from falling below the brace and tease the material as I fill the cavity. No stuffing is placed below the internal brace"

# Alpair 10 MLTL

